

Citta 說明書

重要——請詳細閱讀並保留以備參考。

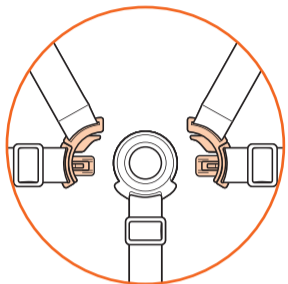

五點式安全帶的使用

1. 扣合：當聽到“咔嚓”聲表示安全帶扣合完成。
 2. 安全帶長度調節：
調長：順著a1方向拉長調節帶，然後順著a2方向拉緊；
縮短：順著b1方向拉長調節帶，然後順著b2方向拉緊。
- 小提示：為了小孩的安全。使用時，請確認安全帶是否扣合到位。

警告 1. 任何時刻都必須使用安全帶。
2. 肩帶扣在插扣片上時，請勿交叉或調節過緊肩帶，以免肩帶對幼兒頸部造成壓迫。

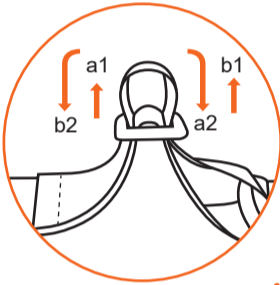
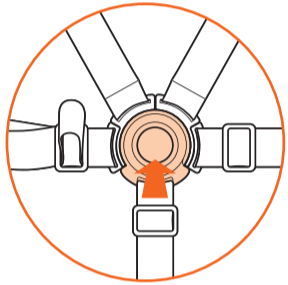

座墊與肩/腰/中央帶套的安裝說明

1. 將座墊穿過坐席上的肩帶，腰帶，中央帶進行安裝。
2. 依次套上肩帶套與中央帶套。

小提示：為了防止肩帶套與中央帶套滑脫，肩帶套內部按扣需與推車肩帶底部按扣進行扣合。中央帶需穿過中央帶套內部鬆緊帶進行固定。

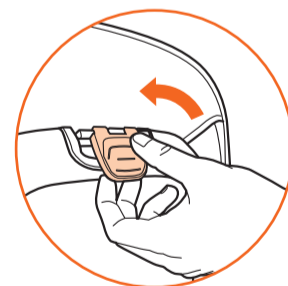
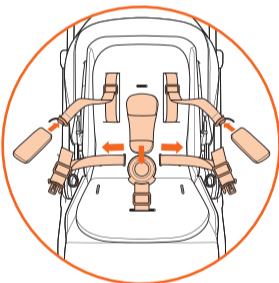
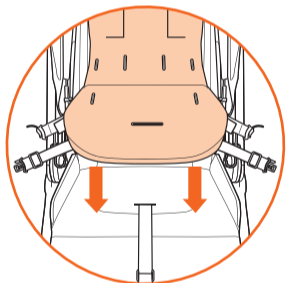

靠背

1. 將頭部後方調節扣向上撥動，即可調節靠背角度。
2. 可調節三段角度（直立、斜躺、平躺）。

注意 請不要連續長時間使用，連續長時間使用會對幼兒造成負擔。躺臥姿勢的連續使用時間上限為 2 小時，坐著姿勢的則為 1 小時。

座椅換向

1. 調整靠背角度，使座椅轉軸處的兩個白色三角形相互對齊，即可向上脫離座椅。
2. 座椅轉向後（請勿對齊三角標誌）向下插入，直至聽到“咔嚓”聲，接頭白色長條標示被完全覆蓋，代表接口結合完成。
3. 請嘗試將座椅向上拉，確認固定無鬆脫，才可安置幼兒。

小提示：請注意安裝手法，避免夾傷。

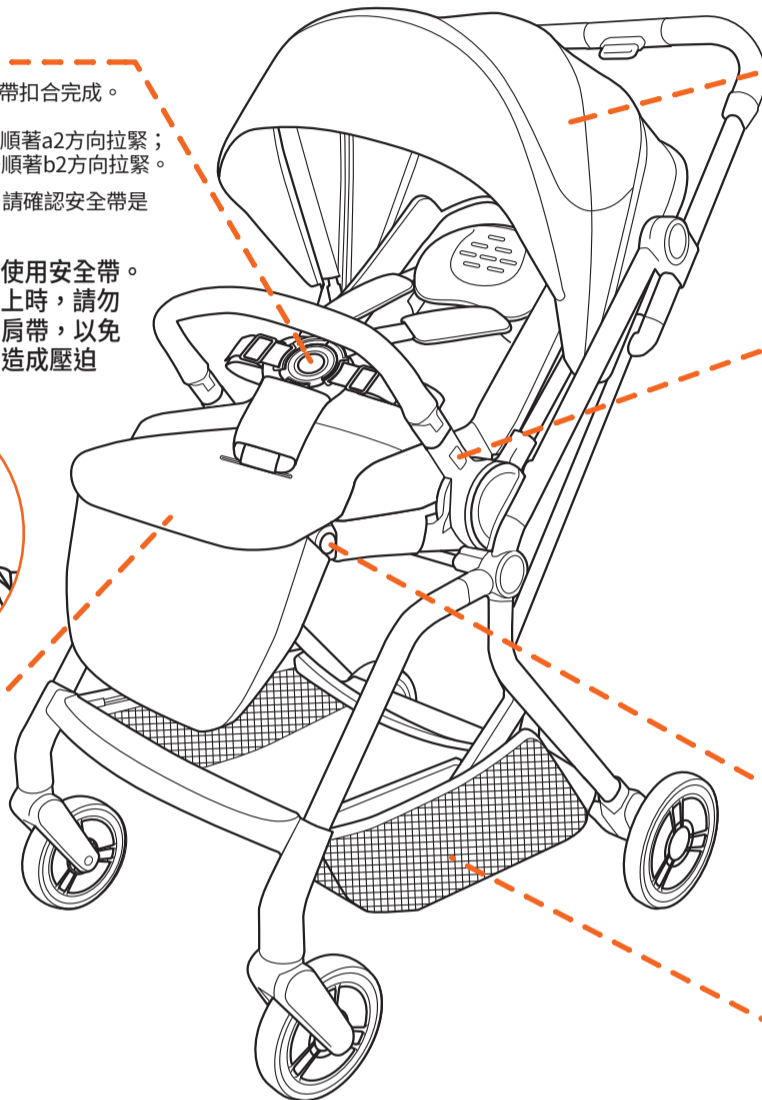
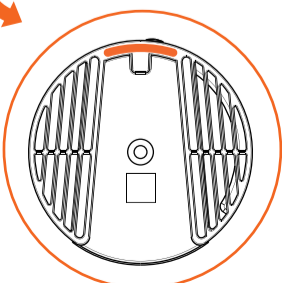
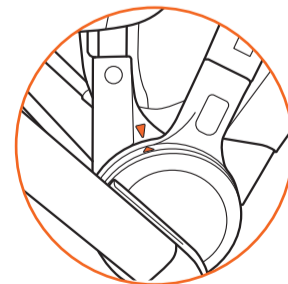

遮陽篷

1. 如圖，向前或向後拉遮陽篷，即可將遮陽篷打開或收攏。
2. 如圖，抓住遮陽篷支架向上拉，直到滑軌定位，即可將遮陽篷升高；若要降低遮陽篷，請抓住支架反向操作。

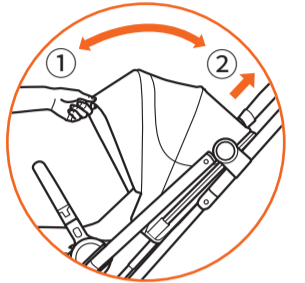

前護欄

前護欄：將前護欄插頭帶有凸出的方形按鈕的滑塊調至與車臺前護欄插座方形孔一致方向後插入，直到聽到“咔嚓”聲。
單邊折下可360°旋轉。

小提示：

1. 安裝前護欄時，請將前護欄按扣對準前護欄座，以免誤組裝，同時請注意安裝手法，避免夾傷。
2. 使用推車時，請留意圖中虛線圈位置間隙以防幼兒手、腳不慎卡入。

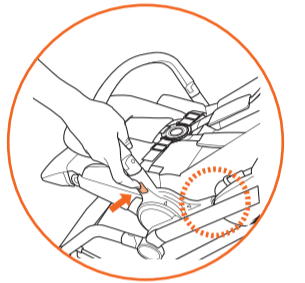

腳托

雙手按下箭頭所指兩側按鈕即可調節腳托角度。

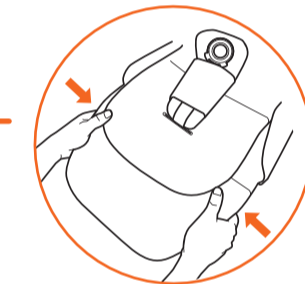

置物籃

置物籃的最大載重量是5kg。

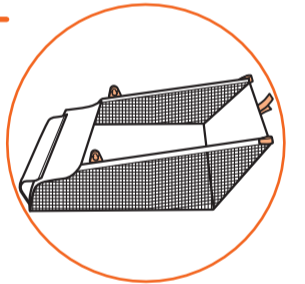

車輪功能

為了方便清潔和收納，後輪設置快拆功能。

1. 按住後輪快拆按鈕H，即可向外拔出後輪。
2. 安裝後輪時，將軸承向內插入後拉動輪子，以確保安裝完成。

小提示：請勿將異物塞入車軸孔洞，可能導致後輪無法正確安裝。

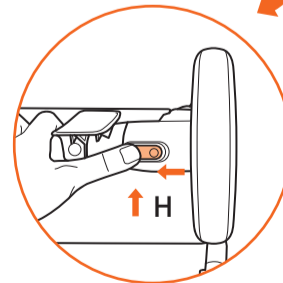
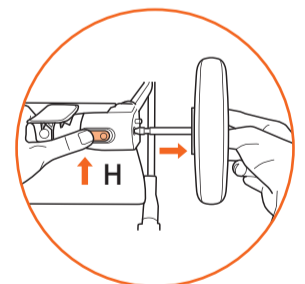

停車鎖

警告 在遠離手推車時，請時刻謹記使用停車鎖。

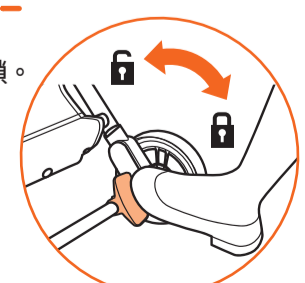

打開手推車

1. 把手向後並往上提，車體展開。
並上下晃動把手確認完全展開並鎖定到位。
3. 往箭頭方向拉開座位，雙手按壓腳托調節按鈕，可調節腳托。

小提示：打開手推車時，請注意打開手法，避免夾傷。

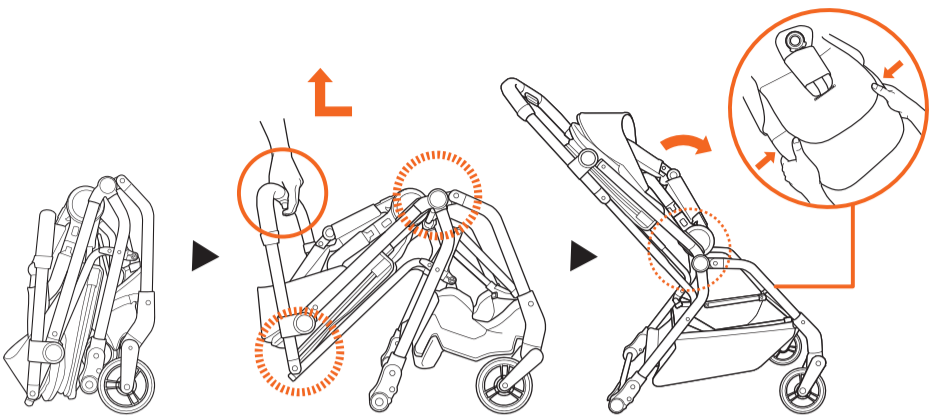

收摺手推車

1. 座椅處於面向前模式，收摺步驟：
 - 1) 調整椅背角度至與把手平行，降低遮陽篷支架高度、收摺遮陽篷，再將腳托向上翻起至椅背平行角度。(如圖①所示)
 - 2) 將安全鎖A向右滑動並壓下開關B，推車即自動收摺。(如圖②、③所示)
2. 座椅處於面對面模式，收摺步驟：
 - 1) 將椅背向把手方向收摺至與把手平行，降低遮陽篷支架高度、收摺遮陽篷，再將腳托向上翻起至椅背平行角度。(如圖④所示)
 - 2) 將安全鎖A向右滑動並壓下開關B，推車即自動收摺。(如圖⑤、⑥所示)

小提示：請注意安裝手法，避免夾傷。

警告

1. 任何覆蓋物及繫帶等捆包物需移除銷燬，或遠離兒童。
2. 當打開 / 收折手推車時必須確認嬰幼兒的肢體與手推車保持安全距離。且操作者切勿觸碰如虛線圈的摺疊機構，以免夾傷。

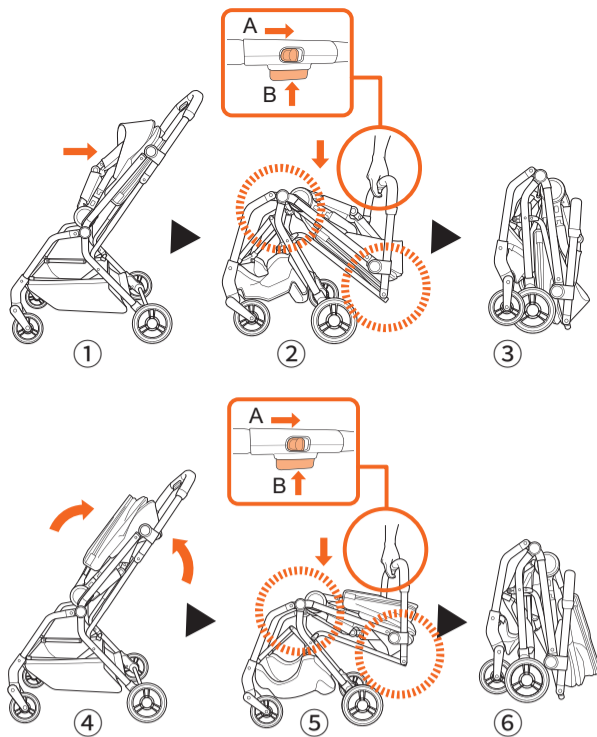

頭枕的安裝方法

請在安裝好座墊後，再使用頭枕。
有關頭枕安裝孔①②的參考：
①大約供1個月至4個月的幼兒使用。
②大約供4個月至7個月的幼兒使用。

警告

1. 為確保肩帶套與中央帶套不會滑脫。穿戴中央帶套時，請注意肩帶內部鈕扣與中央帶套內部鬆緊帶是否固定完成。

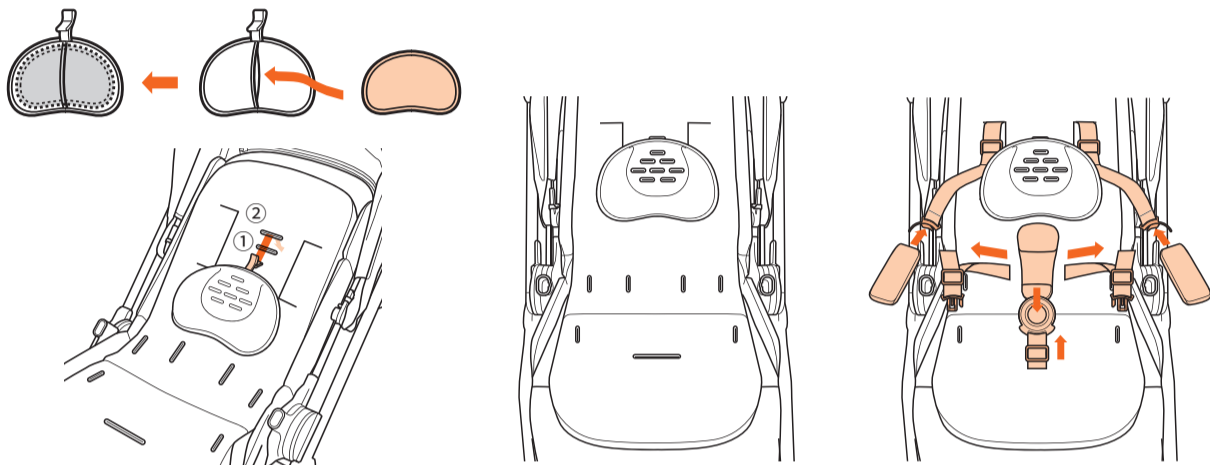

警告 (錯誤操作可能引致重大傷害或死亡)

如果不按照本說明書使用可能會影響兒童的安全。幼兒的安全是您的責任。

- 本產品適用於一個月初生兒至 22 公斤 (大約四歲) 的幼兒。
- 符合 EN 1888-2 : 2018+A1 : 2022 安全标准。
- 不得將嬰幼兒單獨留置車上無人看護。
- 不得同時乘坐二位及以上嬰幼兒或附載其他物品。
- 超載或不正確的摺疊以及使用非經覈准的零附件都可能造成手推車損壞、故障或不安全，請務必閱讀製造商之說明書。
- 使用前應確定車臺豎立及固定各機構以確保安全。
- 為避免傷害，確保展開與折疊本產品時與兒童保持距離。
- 不要讓兒童玩弄本產品。
- 務必隨時使用束縛系統。
- 安全帶或束縛系統必須正確的扣合及使用。
- 當調整手推嬰幼兒車上之任何可活動配件時必須確定嬰幼兒的肢體與車台保持安全距離。
- 嬰幼兒可能會滑入足底部分的缺口或造成窒息。
- 禁止於樓梯間使用手推嬰幼兒車。
- 使用時應遠離高溫、水池或電源之臨近範圍。
- 不可讓幼兒站立在車上，這是十分危險的。
- 不可將手推嬰幼兒車放置於馬路、坡道或危險場所。
- 嬰兒乘坐於手推嬰幼兒車內時，不可將整個車台往上提。
- 請勿手持坐席搬動嬰幼兒車。
- 停泊此手推嬰幼兒車時務必確實使用所有之制動裝置。
- 為防止事故發生，確保手推車 嬰幼兒車遠離自動閉合之門 (例：在火車或電梯上)。
- 本產品僅設計供步行使用。
- 此產品不宜於跑步或滑行時使用。
- 使用前請確保推車所有鎖定裝置都已處於鎖定狀態。
- 為避免窒息的危害，任何覆蓋物及繫帶等捆包物需移除銷燬或遠離兒童。
- 承載超重會容易產生不穩定的危險情況，產品最大承載重量：22 公斤，置物籃最大承載 5 公斤。
- 在已承載幼兒的狀態下調整座席角度時，請重新有調整安全帶至適當長度，請勿一邊推行一邊調整座席角度，注意勿讓座席角度突然改變。
- 當越過不同段差時，若強行附加力量於前車輪上使之與段差碰撞，可能引起手推車損壞和故障，當越過段差時，即使是微小段差區的地方也應減緩推行，並踏上後腳支桿及往後按下把手往前行，確保前車輪越過段差才可通行。
- 跨越火車軌和汽車道的十字路口、排水溝蓋等時，請提高前輪跨越間隙，以免前輪意外卡在溝內引致翻倒。
- 當靠背角度小於 150 度時，不適合 6 個月以下幼兒使用。6 個月以下嬰兒使用，請用最平躺位置。
- 在把手上放置任何負載都會影響車輛的穩定性，請勿將其他產品連接到推把、靠背的背部、手推車的側面等部位。
- 請勿使用未經製造商認可的附屬物。請勿使用非原廠供應的零件替換或自行改裝手推車。
- 當放入 / 抱出孩子或停止手推車時，應鎖定停車鎖，以免轉彎或剎車時令手推車翻倒。
- 不要在嬰兒車裡的嬰兒周圍放置玩具或綁帶的東西。
- 請定期檢查所有螺絲、螺栓和螺母是否擰緊。
- 如手推車出現損壞或操作問題，應立即停止使用，並將其存放在遠離幼童的地方。

保養和清潔

- 切勿強行拉動活動零件或裝置。
- 請勿將產品存放在潮濕的地方以免產品發霉。
- 避免將產品長時間暴露於雨水或雪霜之中。
- 請以濕布清潔。如遇頑固污垢，可使用稀釋的清潔劑。
- 當使用清潔劑擦拭後，請以乾布或海綿將多餘的水分或清潔劑抹淨。
- 擦拭後請置於陰涼處晾乾。
- 若感到手推車車輪轉回不順暢時，可以添加適量的潤滑劑，注意不要添加過多的潤滑劑，否則反而會容易沾上灰塵，引起操作異常。其他部位不可以添加，否則可能引起運作不良。
- 如發現車輪外胎磨耗嚴重，影響推行 / 手推車損壞或有操作問題，請聯絡客服中心 (或當地經銷商)。

香港和東南亞地區消費者請參考下面：

生產商：康貝控股有限公司

供應商：香港九龍旺角太子道西193號新世紀廣場1座16樓1616-1618室康貝香港有限公司

香港和東南亞地區



獲取更多信息
您可以掃描此二維碼

Combi Corporation

Citta

Instruction manual

195646070

IMPORTANT – READ CAREFULLY AND KEEP FOR FUTURE REFERENCE.

Use of five-point safety harness

1. Buckle: When you hear a "click" sound, the safety harness is securely buckled.
 2. Length adjustment of safety harness
 Lengthen: Lengthen the adjustment belt in the direction a1, and then tighten it in the direction a2.
 Shorten: Lengthen the adjustment belt in the direction b1, and then tighten it in the direction b2.
- Note: For the safety of children, please make sure that the safety harness is securely buckled when using the stroller.

⚠ WARNING

1. Always use the restraint system.
2. Do not cross or adjusting it too tight the shoulder belts with each other when securing the shoulder to the insert plastic. Otherwise excessive pressure may be caused to child's neck.

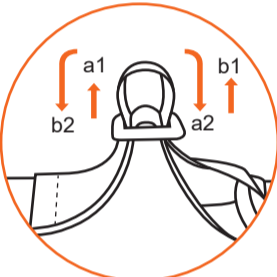
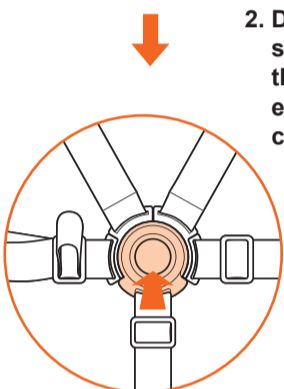
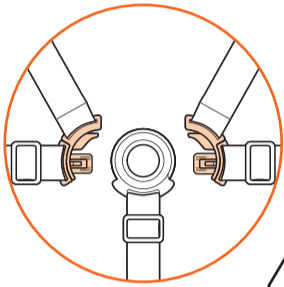

Instructions for installing the seat cushion with shoulder/waist/center strap cover

1. Insert the sleeping mat through the shoulder belt, waist belt, and crotch belt on the seat to install the sleeping mat.
 2. Put on the shoulder belt covers and crotch belt cover in turn.
- Note: To prevent the shoulder belt covers and the crotch belt cover from slipping off, insert the internal buckles of the shoulder belt covers into the bottom buckles of the stroller shoulder belt. To fix the crotch belt, the crotch belt should pass through the internal elastic band of the crotch belt cover.

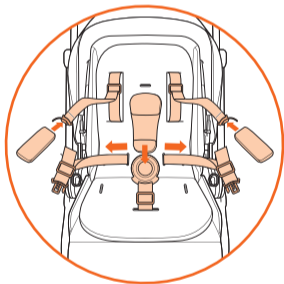
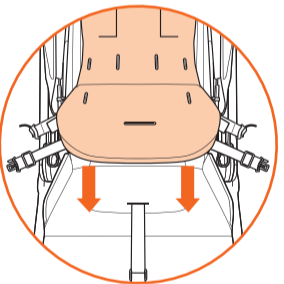

Backrest

1. Push the adjustment buckle behind the head upwards to adjust the backrest angle.
2. Three angles (upright, reclined and flat) are adjustable.

⚠ CAUTION

No continuous use for a long period, continuous use for a long period of time may exhaust baby. No continuous use of more than 2 hours for a baby in a reclined seat and 1 hour in an upright seat.

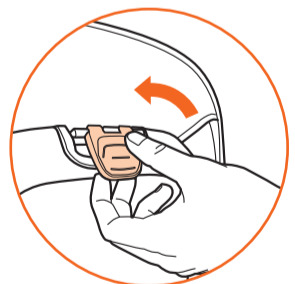

Turn the seat

1. Adjust the backrest to align with the triangle mark on the seat and frame and the seat can be removed for reversal.
 2. After turning the seat (do not align with the triangle mark), insert it downwards until you hear a "click" sound. The white long strip mark on the connector is completely covered, indicating that the joint is fully connected.
 3. Please try to pull the seat up and confirm that it is securely fixed before placing the child.
- Note: please pay attention to installation methods to avoid pinching.

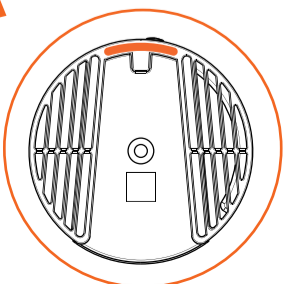
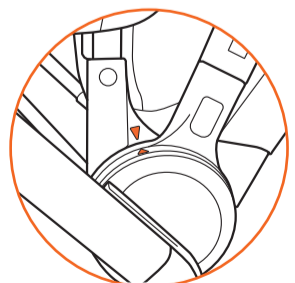

Canopy

1. As shown in the figure, pull the canopy forward or backward to open or close the canopy.
2. As shown in the figure, grasp the canopy bracket and pull it up until the slide rail is positioned, and the canopy can be placed raise and lower; to lower the canopy, grasp the bracket and operate it in reverse.

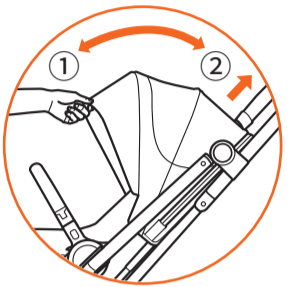

Handrail

Handrail: Adjust the slider with a protruding square button on the handrail plug to align with the square hole of the handrail socket on the stroller and insert it until you hear a "click" sound. Unilateral removal allows for 360° rotation.

- Note: 1. When installing the handrail, please aim the handrail button at the handrail seat to avoid incorrect assembly, and pay attention to the installation method to avoid pinching.
 2. When using the stroller, please pay close attention to the gap of the position marked with dotted lines in the figure to prevent the child's hands and feet from getting stuck accidentally.

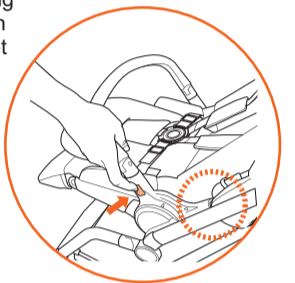

Foot support

Press the buttons on both sides of the arrow with both hands to adjust the foot support.

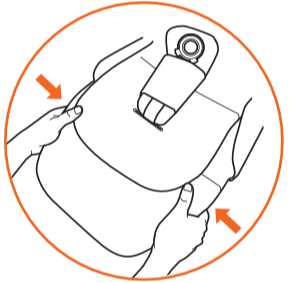

Basket

The basket can carry a maximum weight of 5kg.

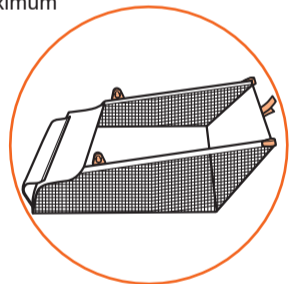

Wheel function

For easy cleaning and storage, the rear wheels support the quick release function.

1. Press and hold the rear wheel quick release button H to pull out the rear wheel.
2. When installing the rear wheel, insert the bearing inward and pull the wheel to ensure the installation is complete.

Note: Do not insert foreign objects into the axle holes because the objects may cause incorrect installation of the rear wheels.

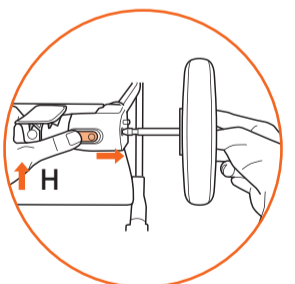

The stopper

⚠ WARNING

Always engage the stopper when you leave the stroller.

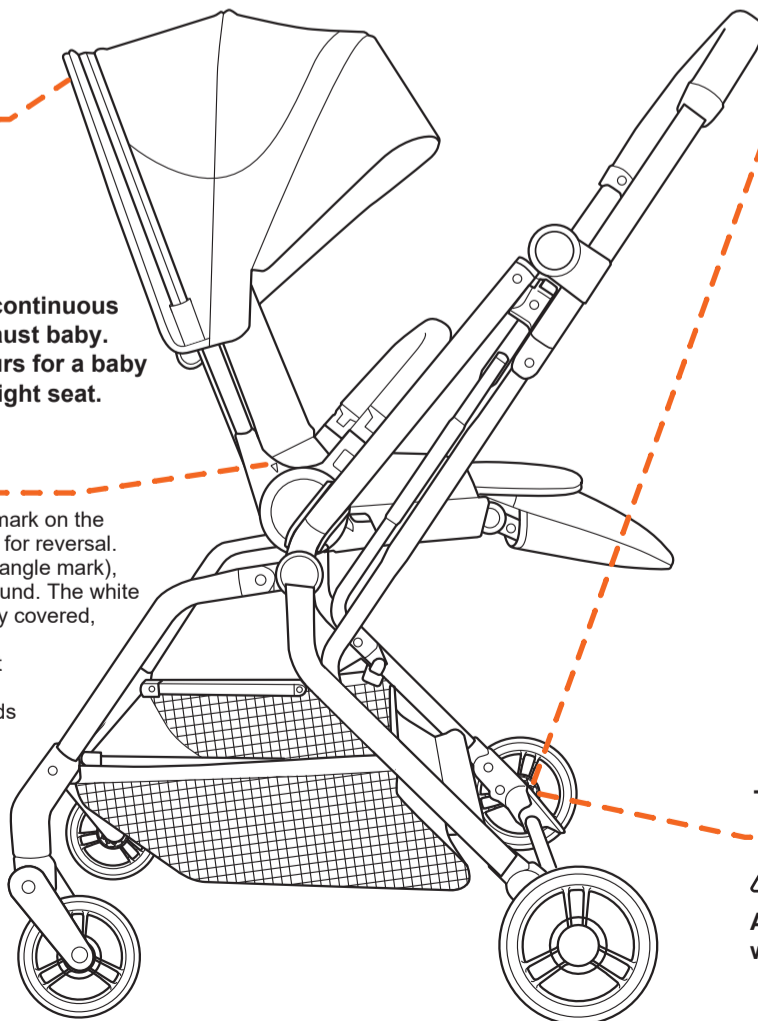
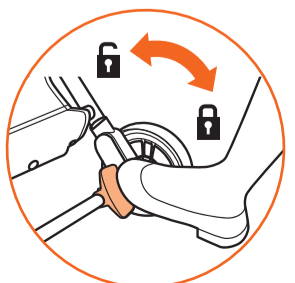

Unfolding the stroller

- Lift the handle backward and upward to unfold the stroller.
Shake the handle up and down to confirm that the stroller is fully unfolded and locked.
 - Pull the seat in the direction of the arrow and press the pedal adjustment button with both hands to adjust the pedal.
- Note: When unfolding the stroller, please pay attention to the installation methods to avoid pinching.

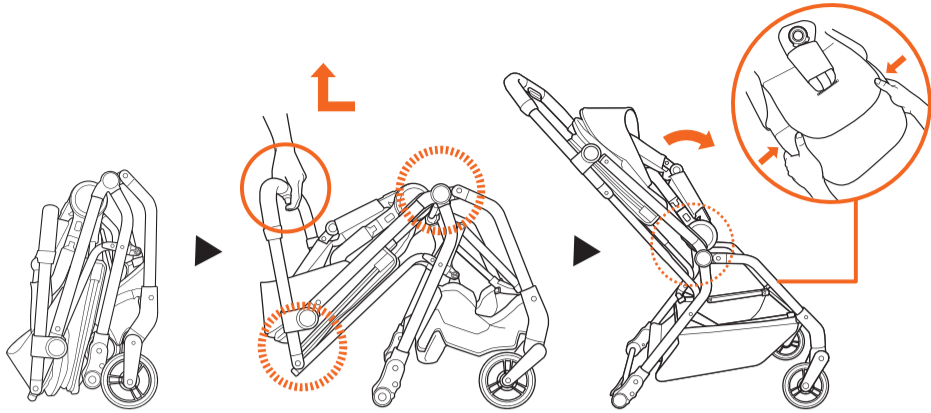

Folding the stroller

- Folding steps when the seat is in facing-forward mode: 1) Adjust the back of the stroller until it is parallel to the handle, lower the height of the canopy bracket, fold the canopy, and then flip the pedals up until they are parallel to the backrest of the stroller. (As shown in Figure ①) 2) Slide the safety lock A to the right and press the switch B. The stroller will be automatically folded. (As shown in Figures ② and ③)
 - Folding steps when the seat is in face-to-face mode: 1) Fold the backrest of the stroller towards the handle until it is parallel to the handle, lower the height of the canopy bracket, fold the canopy, and then flip the pedals up until they are parallel to the backrest of the stroller. (As shown in Figure ④)
- Note: When folding the stroller, please pay attention to the folding methods to avoid pinching.

⚠ WARNING

- Any wrappings such as coverings and cable ties should be removed or kept away from children
- When unfolding/folding the trolley, it must be made clear that the infant's limbs are kept at a safe distance from the trolley. And the operator should not touch the folding mechanism such as the dotted coil to avoid pinching.

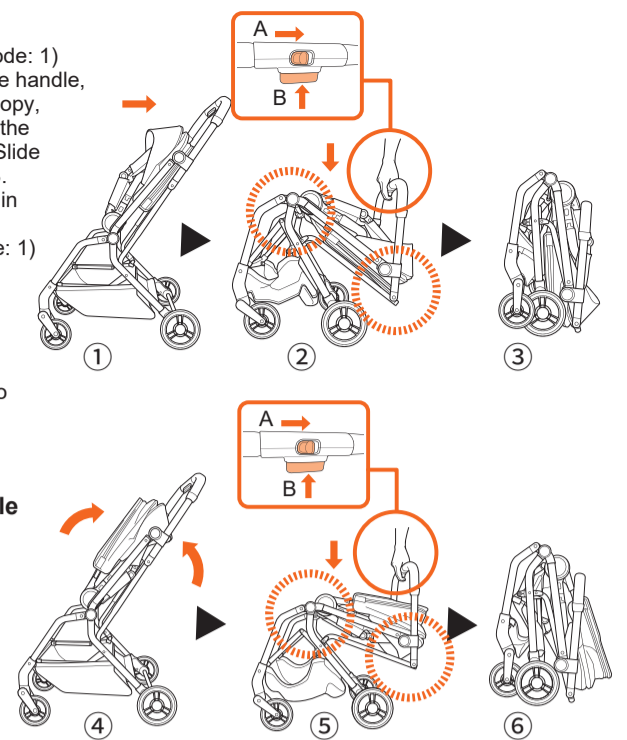

Installing the head cushion

Use the head cushion after installing the Seat cushion.
Reference for head support insert outlets ① and ②:
① suits children aged approximately 1 to 4 months.
② suits children aged approximately 4 to 7 months.

⚠ WARNING

- To prevent the shoulder belt covers and crotch belt cover from slipping off, when putting on the crotch belt cover, check whether the internal buttons of the shoulder belts are inserted into the elastic band inside the crotch belt cover.

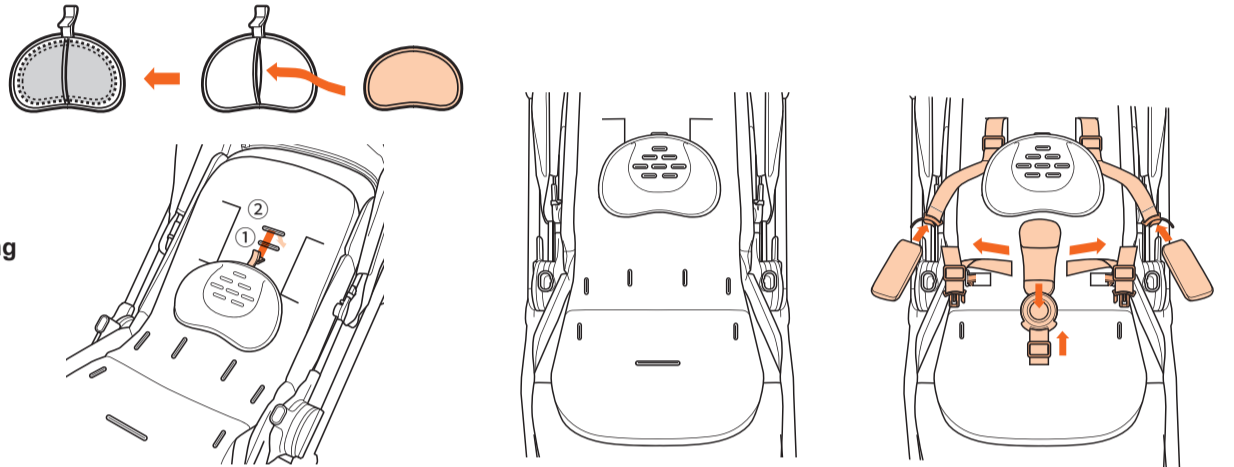

⚠ WARNING (Incorrect operation may cause serious injury or death)

The safety of the child may be seriously endangered if the instructions are not followed. You are personally responsible for the safety of your child.

- The stroller is suitable for children from newborn 1 month to 22kg (approximately 4 years old).
- Under EN 1888-2:2018+A1:2022 safety standard.
- Never leave the child unattended.
- The stroller is not allowed to carry two or more children or other items at the same time.
- Overloading, incorrect folding and the use of non-approved accessories may damage this stroller.
- Ensure that all the locking devices are engaged before use.
- To avoid injury ensure that the child is kept away when unfolding and folding this product.
- Do not let the child play with this product.
- Always use the restraint system to avoid any possible accident.
- The safety harness or restraint system must be correctly buckled and used.
- When adjusting any movable parts on the stroller, keep a safe distance between the child's limbs and the stroller.
- The child may slip into gaps near the sole of its feet, which may cause suffocation.
- Do not use the stroller on stairs.
- Do not place the stroller near fire, high temperature, pool, or electric source.
- Do not allow your child to stand in or on the stroller, it may be dangerous
- Do not leave the stroller on roads, ramps or any other dangerous places.
- Do not lift stroller while child is in stroller.
- Do not move the stroller by holding the seat.
- Be sure to use all braking devices when parking the stroller.
- To prevent accidents, ensure that the stroller is kept away from any automatically closing doors (for example, doors of train or elevator).
- This product is not suitable for running or skating.
- To avoid the risk of suffocation, any coverings and binding straps must be removed, destroyed or kept away from the child.
- Excessive weight may cause a hazardous and unstable condition exist. (Maximum load:22kg. Basket maximum load:5kg).
- When adjusting the seat angle with a child seated in the stroller, please readjust the safety harness to a proper length. Do not adjust the seat angle while you are moving the stroller. Do not suddenly change the seat angle.
- If one gives excessive shock to the front wheels when getting over the step, stroller may fall down and cause damages. When stepping over, such as a curb, please slow down even a slight difference level, pull downward the handle and step on the foot-step, and make sure to pass the front wheels to get over the step.
- Lift front wheels and pay particular attention to gaps or ditch when crossing rail road to avoid the front wheels from accidentally getting to jammed and tipping over.
- Do not use in a reclined angle less than 150° for a child under 6 months old. when a child under 6 months old, please use of the most reclined position.
- Any loading attached to the handle affects the stability of the stroller, on the back of the backrest and/or on the sides of stroller will affect the stability of the stroller.
- Only replacement parts supplied or recommended by the manufacturer/distributor shall be used. Only use original accessories and parts that have been approved by the manufacturer. Do not make any modifications to the product.
- The parking device shall be engaged when placing and removing the children or stop the stroller, in case of sudden brake or turning, and then the stroller may fall off.
- Do not place toys or things with straps attached around the infant riding around in a baby carriage.
- Check regularly that all screws, bolts and nuts are engaged tightly.
- In the event of damage or operation problems, stop using the stroller immediately and keep it out of reach of children.

Maintenance and Cleaning

- Never apply force on any mechanism or moving parts.
- To prevent mildew forming, do not store this product in a wet or humid environment.
- Avoid prolonged exposure of the product to rain or snow.
- Clean with a wet cloth. For stubborn stains, use a diluted mild detergent.
- After wipe off the dirt by detergent, use a cloth to wipe off the excess water and detergent.
- Dry in shade area after wipe off water.
- You may lubricate moving parts if the Wheel turning part of the stroller is not smooth, Please do not apply any lubricating oil other part that will cause malfunction. Please do not apply any lubricating oil other part that will cause malfunction.
- In the event of if you find the tyre wear seriously affect movement/ stroller damage or operation problems, please contact customer service center.

Consumers from Hong Kong and South East Asia countries please refer to below

Manufacturer: Combi Holdings Limited
Supplier: Combi Hong Kong Limited Units 1616-18, 16/F, Tower 1, Grand Century Place, 193 Prince Edward Road West, Mongkok, Kowloon, Hong Kong

Hong Kong and South East Asia countries



For more information, you can scan this QR code.

Combi Corporation